

Sherrill Hall at Lesley University / Cambridge, Massachusetts



Owner:
Lesley University

Architect:
Prellwitz Chilinski Associates

Area:
19,000sf

Duration:
6.5 Months

Type:
Renovation

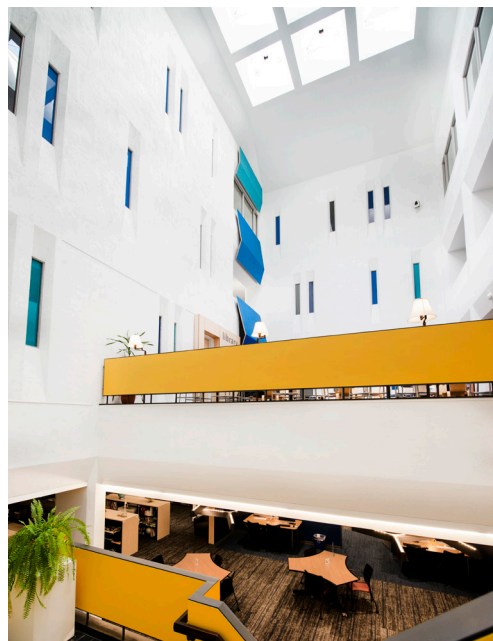

Lesley University teamed with Prellwitz Chilinski Associates and Erland Construction to revamp 19,000sf within Sherrill Hall, an existing library and classroom building on the school's Cambridge campus. The 6.5-month renovation revitalized the building's use for students, faculty and staff; creating new places to learn, study, and interact with one another.

After extensive demo and abatement, the first floor of the building was outfitted with a new study room, café, and conference rooms as well as offices, workstations, and lounge seating. The basement level, where majority of the library's books are stored, also received an upgrade including the installation of compact shelving and student lockers. The ceilings on both floors required a complete overhaul to accommodate a new fire safety system. Erland also increased the electrical power and data capacity within the space.

Sherrill Hall remained occupied throughout construction. Erland maintained accessibility to the library and minimized disruption to its ongoing operations by establishing a logistics plan and staggered approach focused on safety. All personnel were required to badge into the jobsite for the duration of the project.